

Drain: VILLAGE PLAZA DRAIN **Drain #:** 220
Improvement/Arm: VILLAGE PLAZA-SECTION 4
Operator: JOH **Date:** 7-30-04
Drain Classification: Urban/Rural **Year Installed:** 1987

GIS Drain Input Checklist

- Pull Source Documents for Scanning JOH
- Digitize & Attribute Tile Drains N/A
- Digitize & Attribute Storm Drains JOH
- Digitize & Attribute SSD N/A
- Digitize & Attribute Open Ditch JOH
- Stamp Plans JOH
- Sum drain lengths & Validate JOH
- Enter Improvements into Posse JOH
- Enter Drain Age into Posse _____
- Sum drain length for Watershed in Posse _____
- Check Database entries for errors JOH



SURVEYOR'S OFFICE

Hamilton County

Kenton C. Ward, Surveyor

776-9626

Noblesville, Ind. 46060

FILED

October 4 1986 1986

HAMILTON COUNTY DRAINAGE BOARD

Nancy J. Oldham
SECRETARY

To: Hamilton County Drainage Board

Re: Village Plaza Drain

Attached are the petition, non-enforcement request, plans, calculations and assessment roll for the Village Plaza Drain. I have reviewed the submittals and petition and have found each to be in proper form.

I have made a personal inspection of the land described in the petition. Upon doing so, I believe that the drain is practicable; will improve the public health; benefit a public highway and be of public utility; and that the costs, damages and expenses of the proposed drain will probably be less than the benefits accruing to the owners of land likely to be benefitted. The drain will consist of the following:

12" RCP	370'
15" RCP	498'
21" RCP	50'
24" RCP	520'

The total length of the drain will be 1438'.

The drain will be extended across lots 7 and 20 at such time as those lots are developed. The extensions across these lots will also become part of the regulated drain. The development plan for these will be submitted for the Boards approval at a later date.

FILED
3 1986
BY DRAINAGE
Nancy J. Oldham

I have reviewed the plans and believe the drain will benefit each lot equally. Therefore, I recommend each lot be assessed equally. I recommend a maintenance assessment of \$20.00 per acre, \$25.00 for roadways, with a \$25.00 minimum. With this assessment the total annual assessment for the drain this section will be \$409.68. I recommend the drain be classified as an urban drain.

I recommend a hearing be set for December 8, 1986.

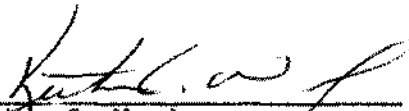

Kenton C. Ward,
Hamilton County Surveyor

KCW/jh

CERTIFICATE OF COMPLETION AND COMPLIANCE

TO: HAMILTON COUNTY SURVEYOR

RE: Village Plaza Drain

I hereby certify that:

- 1.) I am a Registered Land Surveyor in the State of Indiana,
- 2.) I am familiar with the plans and specifications for the above referenced subdivision,
- 3.) I have personally observed and supervised the completion of the Drainage Facilities for the above referenced subdivision, and
- 4.) To the best of my knowledge, information and belief, the Drainage Facilities within the subdivision has been installed and completed in conformity with all plans and specifications.

Signature: Allan H. Weihe Date: 9-16-87
Type or Printed Name: Allan H. Weihe
Business Address: 10505 N. College Ave.
Indianapolis, Indiana 46280
Telephone: 846-6611

INDIANA REGISTRATION NUMBER

#10398

SEAL



FILED

SEP 18 1987

HAMILTON COUNTY DRAINAGE BOARD

SECRETARY



SURVEYOR'S OFFICE
Hamilton County

Kenton C. Ward, Surveyor

~~573-6110 Ext. 19~~

Noblesville, Ind. 46060 October 16, 1987

TO: Hamilton County Drainage Board

RE: Village Plaza Drain

On October 16, 1987 an inspection was made of the drainage facilities for Village Plaza. At that time I found the project to be complete and acceptable.

The proposed length of the drain was slightly changed during construction. However, the overall drainage concept remained the same. The new lengths are as follows:

12" RCP	334.5 feet	21" RCP	50.0 feet
15" RCP	496.5 feet	24" RCP	515.5 feet

The total length of the drain is now 1396.5 feet.

The required submittals have been made and are in proper order. Therefore, I recommend the Board approve the drainage facilities as complete and accept the drain as constructed.

I further recommend the Board approve the attached non-enforcement of easement.

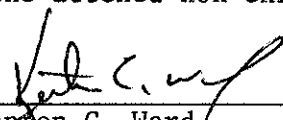
Kenton C. Ward
Hamilton County Surveyor

KCW/no

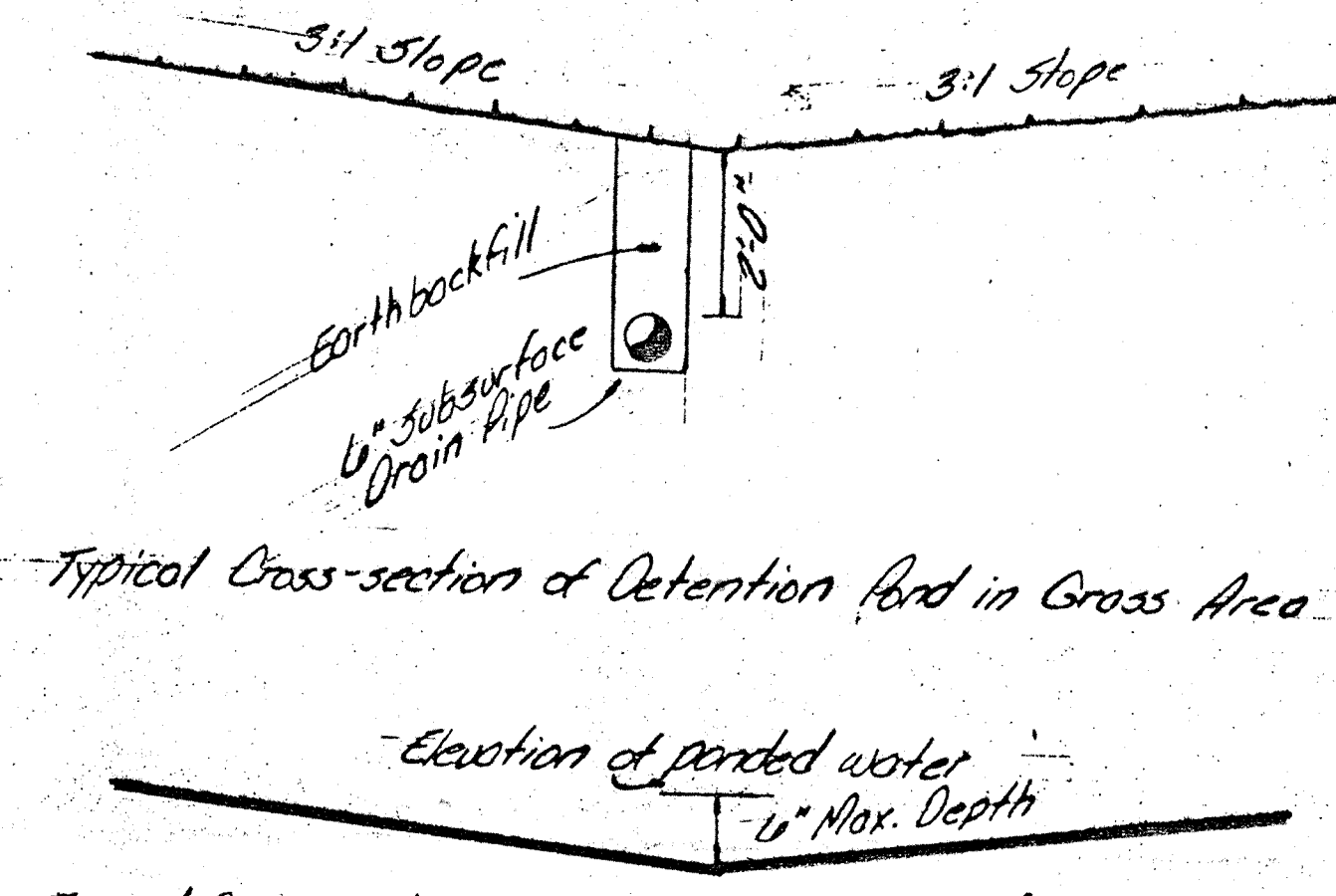
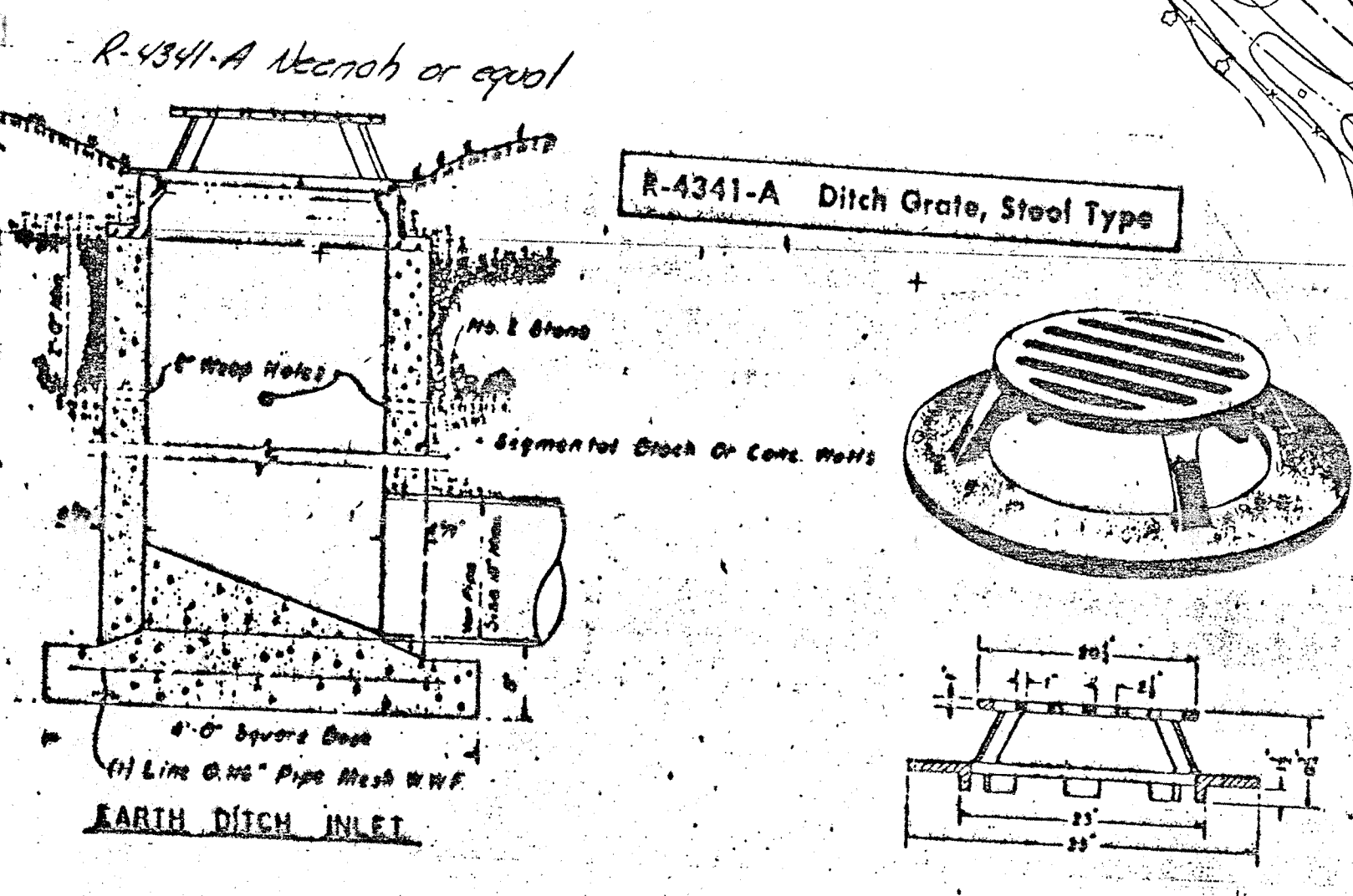
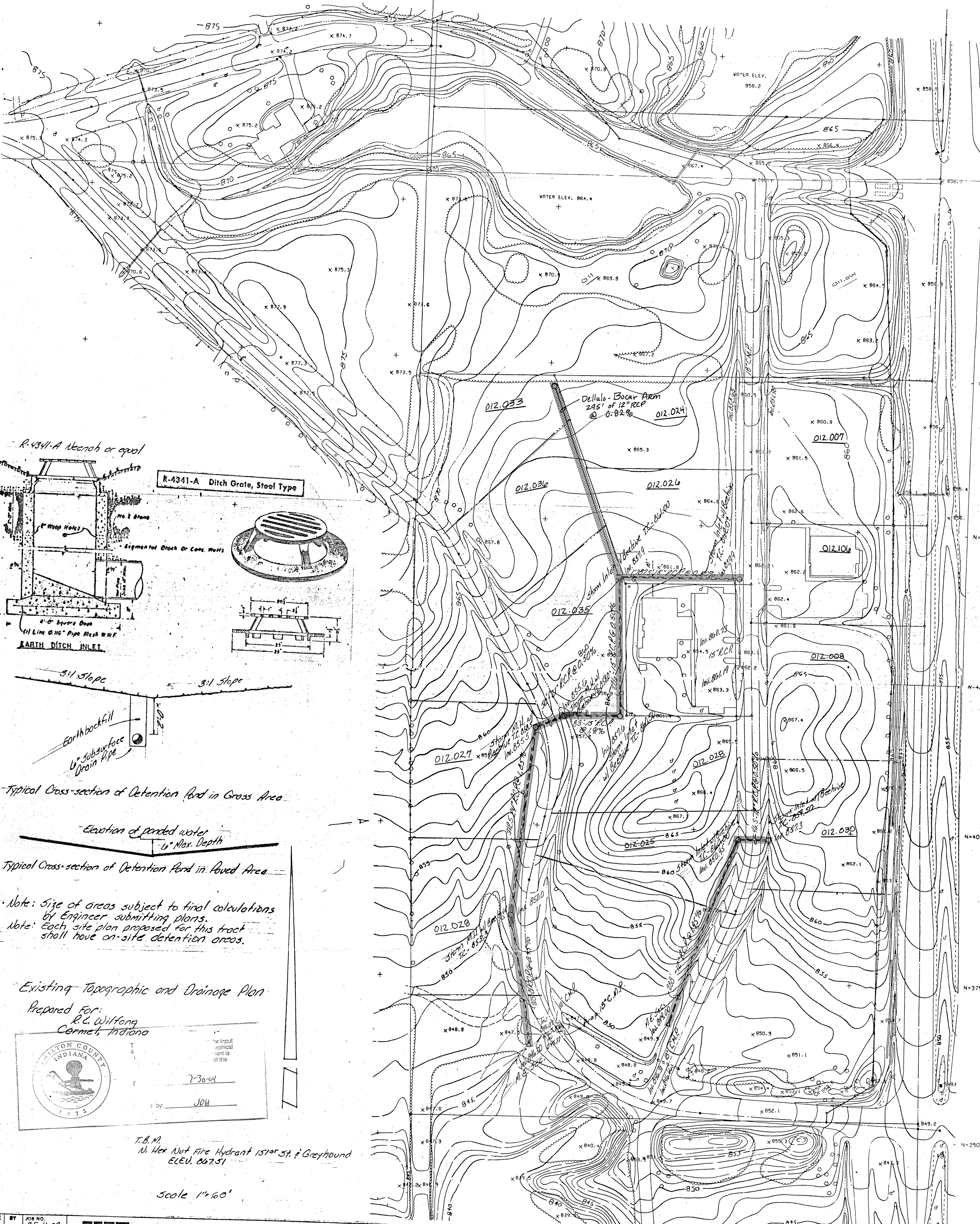

Note: Size of areas subject to final calculations by Engineer submitting plans.
 Note: Each site plan proposed for this tract shall have on-site detention areas.

Existing Topographic and Drainage Plan
 Prepared For:
 R.C. Wilfong
 Carmel, Indiana

7-30-04
 JWH

T.B.M.
 N. Hex Nut Fire Hydrant 151st St. & Greyhound
 ELEV. 867.51

Scale 1"=60'

DATE BY JOB NO. 85-1400
 DRAWN BY D.B.
 CHECKED BY
 DATE 12-2-85

WEIHE ENGINEERS INC.
 10505 NORTH COLLEGE AVENUE
 INDIANAPOLIS, INDIANA 46280
 (317) 846-6611

ALLAN H. WEIHE, P.E., L.S.
 PRESIDENT

CIVIL ENGINEERS LAND SURVEYORS LAND PLANNERS

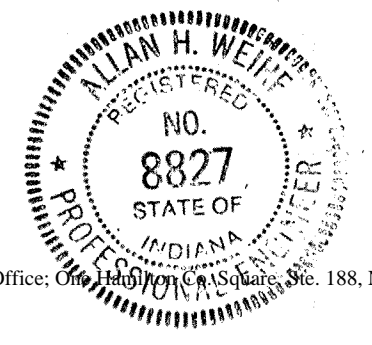

"RECORD DRAWING" 9/15/87
 Allan H. Weihe
 ALLAN H. WEIHE, Reg. P.E. INDIANA 8827